

**RN-100/150-2,3,4 • RN-200/250/300-2,3**

MULTI-FACE PLATE, MULTI-SPINDLE TABLE • PNEUMATIC CLAMPING

These high speed, multi-spindle rotary tables are particularly suited for multi-spindle vertical machining centers. The compact, multi-spindle RN-100 is ideal for use on drilling and tapping machines.



**Specifications ►**

Dimensions = mm

Table Model	RN-100-2,3,4			RN-150-2,3,4			RN-200-2,3		RN-250-2,3		RN-300-2,3			
Versions available	R, L			R			R		R		R			
Spindle outer diameter	mm 80h7			100h7			120h7		-		-			
Table diameter (optional)	mm (115)			(160)			(200)		250		320			
Center height	mm 135			135			160		160		210			
Center bore	Nose Diameter	mm 50H7		55H7		65H7		75H7		110H7				
	Thru Diameter	mm 30		40		45		45		85				
Table T-slot width (with face plate)	(10H8)			(12H8)			(12H8)		12H8		14H8			
Minimum spindle center distance	120			215			250		300		380			
Guide block width	18h7			14h7			18h7		18h7		18h7			
Servo motor (Fanuc)*	Alpha 4i			α2i	Alpha 3,4i		Alpha 8i		Alpha 8i		Alpha 12i			
Maximum motor speed	rpm 5,000			5,000	4,000		4,000		3,000		3,000			
Speed reduction ratio	1/36			1/90	1/180		1/90		1/120	1/180	1/120			
Number of spindles	2	3	4	2	3	4	2	3	2	3	2	3		
Maximum table speed	rpm 138.9			55.5	44.4	22.2	44.4		25	16.7	25			
Inertia converted into motor shaft	x 10 <sup>-3</sup> kg·m <sup>2</sup> .64			.92	1.06	.42	.78	.39	.55	.92	.84	.63	2.09	2.63
Clamp system	Pneumatic													
Clamp torque @72psi	Nm (ft. lbs.) 80 (59)			156 (115)			294 (217)		441 (325)		880 (649)			
Indexing accuracy	arc sec. ±30			±15										
Repeatability	arc sec. ±2													
Net Weight [dual spindle]	kg (lbs.) 70-110 (154-242)			[120 (264)]			[160 (352)]		[240 (528)]		[480 (1,056)]			
Allowable wheel torque	Nm (ft. lbs.) 178 (131)			147 (108)			245 (181)		470 (346)		764 (563)			
Allowable work inertia	kg·m <sup>2</sup> .10			.48			1.2		2.0		3.7			
Allowable work weight		kg (lbs) [w/ tailstock]		25 (55) [50 (110)]		75 (165) [150 (330)]		100 (220) [250 (550)]		100 (220) [250 (550)]		150 (330) [350 (770)]		
		kg (lbs)		50 (110)		150 (330)		250 (550)		250 (550)		350 (770)		
Allowable load when table clamped		N (lbf)		5,880 (1,317)		7,840 (1,756)		13,720 (3,073)		13,720 (3,073)		19,600 (4,390)		
		Nm (ft. lbs.)		80 (59)		156 (115)		294 (217)		441 (325)		880 (649)		
		Nm (ft. lbs.)		156 (115)		392 (289)		980 (722)		980 (722)		1,960 (1,444)		

\* Other motors & RPM available

Specifications subject to change without notice

# NC Rotary Tables ▶ Multi-Face Plate, Multi-Spindle Models

## Dimensions ▶

Drawings not to scale • Dimensions = mm

### RN-100R-2,3,4

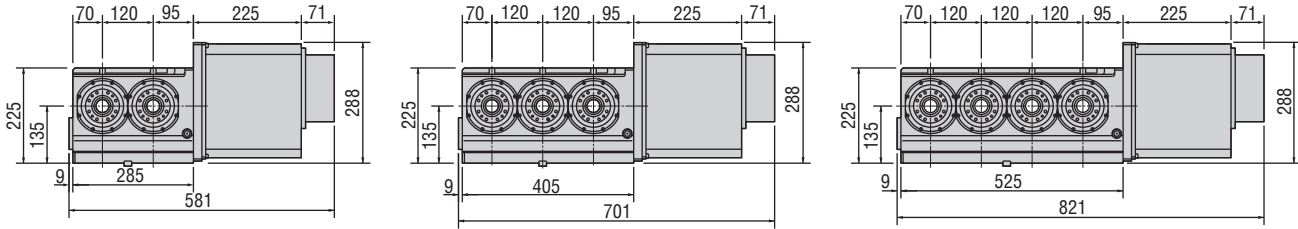

### RN-150R-2 (3 & 4 spindle models also available)

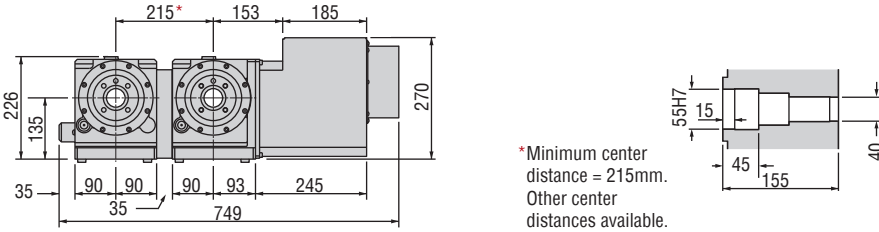

### • RN-250-2

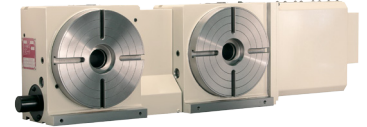

### • RN-100-2 w/5C Collets

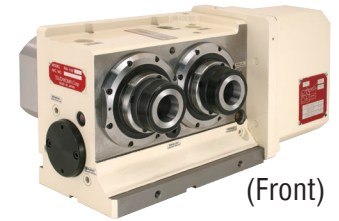

### RN-200R-2 (3 spindle model also available)

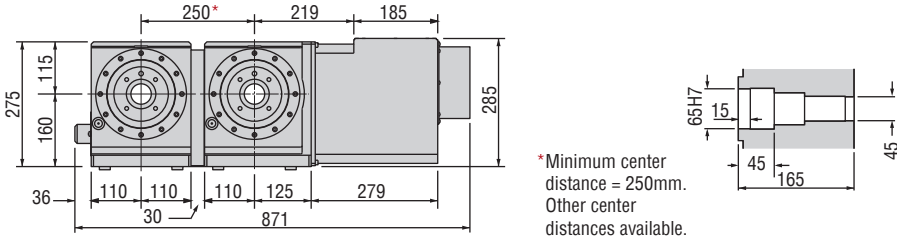

### RN-250R-2 (3 spindle model also available)

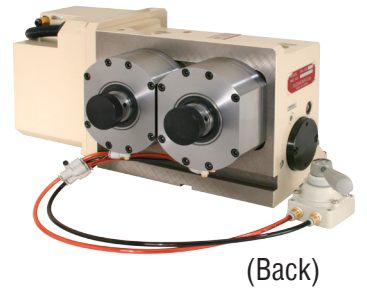
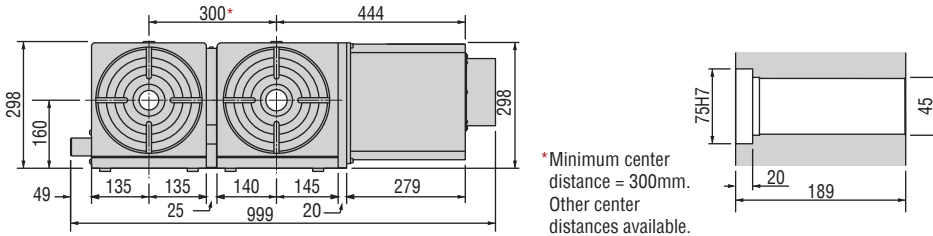

### RN-300R-2 (3 spindle model also available)

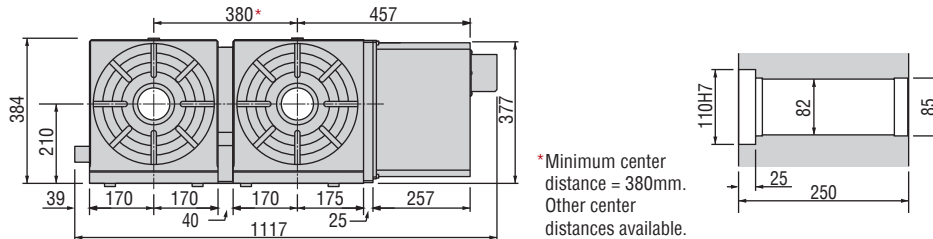

### Options & Accessories

TPC NC Controller	p.66
Chucks	p.77
Tailstock	p.79
Support Spindle	p.79
Face Plate	p.81
Encoder / Scale	p.82
Pull Stud Device	p.83
Rotary Joint	p.83
PVC or Steel Cables	p.84

The dimensions above are for tables with a FANUC servo motor. Other motors available (dimensions may increase).

## Clamping Block and Bolt ▶

Dimensions = mm

	Type	Q'ty	T-Slot Width	A	B	C	D	E	F	G	H	I	J	K	L	M
RN-100R	I	2	18	25	12	80	12	33	35	22	21	11	65	40	28	16
RN-150R	I	2	18	25	12	80	12	33	35	22	21	11	65	40	28	16
RN-200R	I	2	18	25	12	80	12	33	35	22	21	11	65	40	28	16
RN-250R	I	4	18	25	12	80	12	33	35	22	21	11	65	40	28	16
RN-300R	I	4	18	30	15	90	16	31	43	25	21	11	70	46	28	16

### Type I

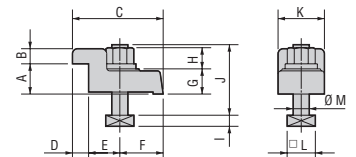

Note: When using a machine with a T-slot pitch other than the above, use suitable clamping blocks and bolts that are available on the market, or order custom-made ones from KOMA (opt.)